

Revised on:	00/00/00 BG
Revised on:	00/00/00 BG
Revised on:	00/00/00 BG
Revised on:	00/00/00 BG
Revised on:	00/00/00 BG
Revised on:	00/00/00 BG

BOOTH COUNT:

Expo Hall as of 10/29/2009

Dimension	Size	Qty	SqFt
10x10'	100	90	9,000
20x20'	400	1	400
20x30'	600	3	1,800
20x50'	1,000	1	1,000
30x40'	1,200	1	1,200
30x60'	1,800	1	1,800
40x50'	2,000	1	2,000
50x50'	2,500	2	5,000
60x60'	3,600	4	14,400
70x120'	8,400	1	8,400
80x80'	6,400	1	6,400
Totals:	106		51,400

EXPO HALL

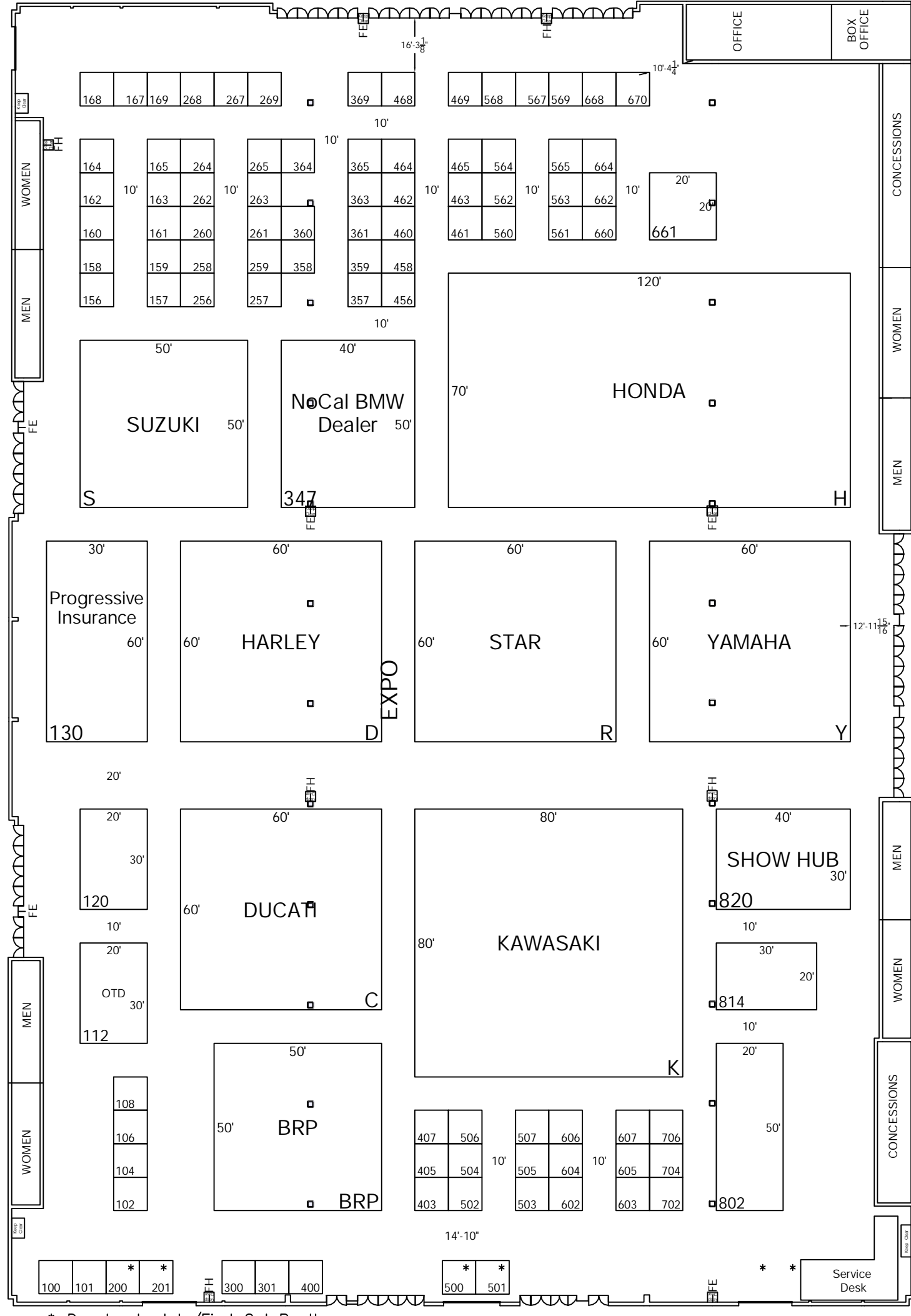

*-Denotes Last In/First Out Booths

FREEMAN

105 PARK LANE
 BRISBANE, CA 94105
 Phone: 415-330-6200
 Fax: 415-330-6201

SAN FRANCISCO
 DRAFTING & DESIGN

File Name:	.DWG
Show Name:	XXX XXX
Show Dates:	XXX
Facility:	XXX
Job Number:	XXX
Acct. Exec:	DB

Scale: NTS

DISCLAIMER
 EVERY EFFORT HAS BEEN MADE TO ENSURE THE ACCURACY OF ALL INFORMATION CONTAINED ON THIS FLOORPLAN. HOWEVER NO WARRANTIES, EITHER EXPRESSED OR IMPLIED ARE MADE WITH RESPECT TO THIS FLOORPLAN. IF THE LOCATION OF BUILDING COLUMNS, UTILITIES OR OTHER ARCHITECTURAL COMPONENTS OF THE FACILITY IS A CONSIDERATION IN THE CONSTRUCTION OR USAGE OF AN EXHIBIT, IT IS THE SOLE RESPONSIBILITY OF THE EXHIBITOR TO PHYSICALLY INSPECT THE FACILITY TO VERIFY ALL DIMENSIONS AND LOCATIONS.
 ©RIGHT 2009, FREEMAN DRAFTING & DESIGN. ALL RIGHTS RESERVED.

NO CA INTL MOTORCYCLE
 NOVEMBER 20-22, 2009
 SAN MATEO EXPO CENTER-EXPO HALL
 SAN MATEO, CALIFORNIA

Revised on:	00/00/00 BG
Revised on:	00/00/00 BG
Revised on:	00/00/00 BG
Revised on:	00/00/00 BG
Revised on:	00/00/00 BG
Revised on:	00/00/00 BG

BOOTH COUNT:

Fiesta Hall as of 10/29/2009

Dimension	Size	Qty	SqFt
10x10'	100	59	5,900
20x20'	400	4	1,600
20x30'	600	1	600
60x80'	4,800	1	4,800
60x90'	5,400	1	5,400
Totals:	66	18,300	

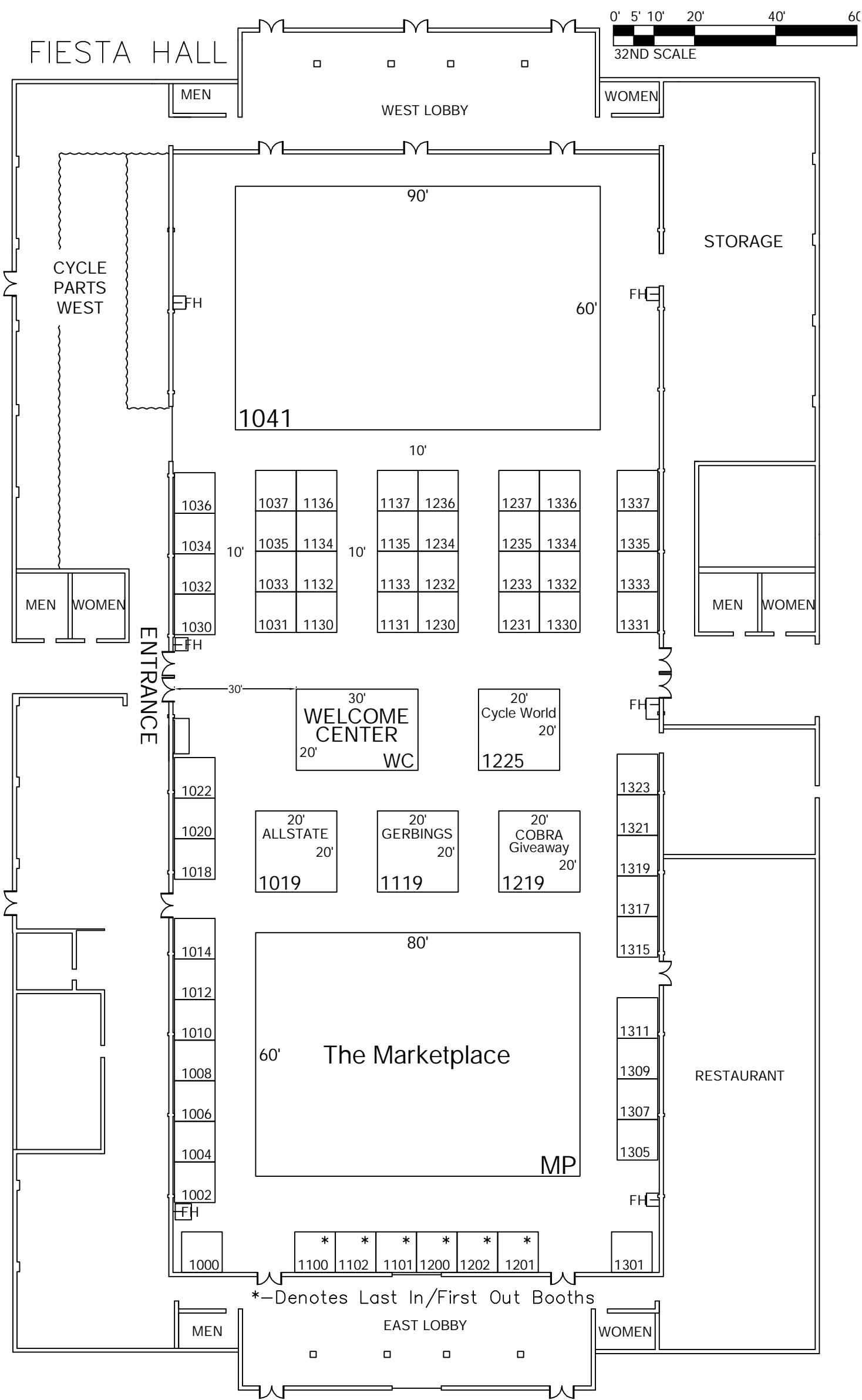

*-Denotes Last In/First Out Booths

NO CA INTL MOTORCYCLE
 NOVEMBER 20-22, 2009
 SAN MATEO EXPO CENTER-FIESTA HALL
 SAN MATEO, CALIFORNIA

FREEMAN

105 PARK LANE
 BRISBANE, CA 94105
 Phone: 415-330-6200
 Fax: 415-330-6201

SAN FRANCISCO
 DRAFTING & DESIGN

File Name:	.DWG
Show Name:	XXX XXX
Show Dates:	XXX
Facility:	XXX
Job Number:	XXX
Acct. Exec:	DB

Scale: NTS

DISCLAIMER
 EVERY EFFORT HAS BEEN MADE TO ENSURE THE ACCURACY OF ALL INFORMATION CONTAINED ON THIS FLOORPLAN. HOWEVER NO WARRANTIES, EITHER EXPRESSED OR IMPLIED ARE MADE WITH RESPECT TO THIS FLOORPLAN. IF THE LOCATION OF BUILDING COLUMNS, UTILITIES OR OTHER ARCHITECTURAL COMPONENTS OF THE FACILITY IS A CONSIDERATION IN THE CONSTRUCTION OR USAGE OF AN EXHIBIT, IT IS THE SOLE RESPONSIBILITY OF THE EXHIBITOR TO PHYSICALLY INSPECT THE FACILITY TO VERIFY ALL DIMENSIONS AND LOCATIONS.
 ©RIGHT 2005, FREEMAN DRAFTING & DESIGN. ALL RIGHTS RESERVED.

Revised on:	00/00/00 BG
Revised on:	00/00/00 BG
Revised on:	00/00/00 BG
Revised on:	00/00/00 BG
Revised on:	00/00/00 BG
Revised on:	00/00/00 BG
Revised on:	00/00/00 BG
Revised on:	00/00/00 BG
Revised on:	00/00/00 BG
Revised on:	00/00/00 BG

BOOTH COUNT Totals: 61 18,500

Redwood Hall as of 10/28/2009

Dimension	Size	Qty	SqFt
10'x10'	100	44	4,400
20'x40'	800	1	800
30'x40'	1,200	1	1,200
Totals:			46 6,400

Sequoia Hall as of 10/28/2009

Dimension	Size	Qty	SqFt
10'x10'	100	30	3,000
Totals:			30 3,000

Pavilion Meeting Rm as of 10/28/2009

Dimension	Size	Qty	SqFt
10'x10'	100	25	2,500
Totals:			25 2,500

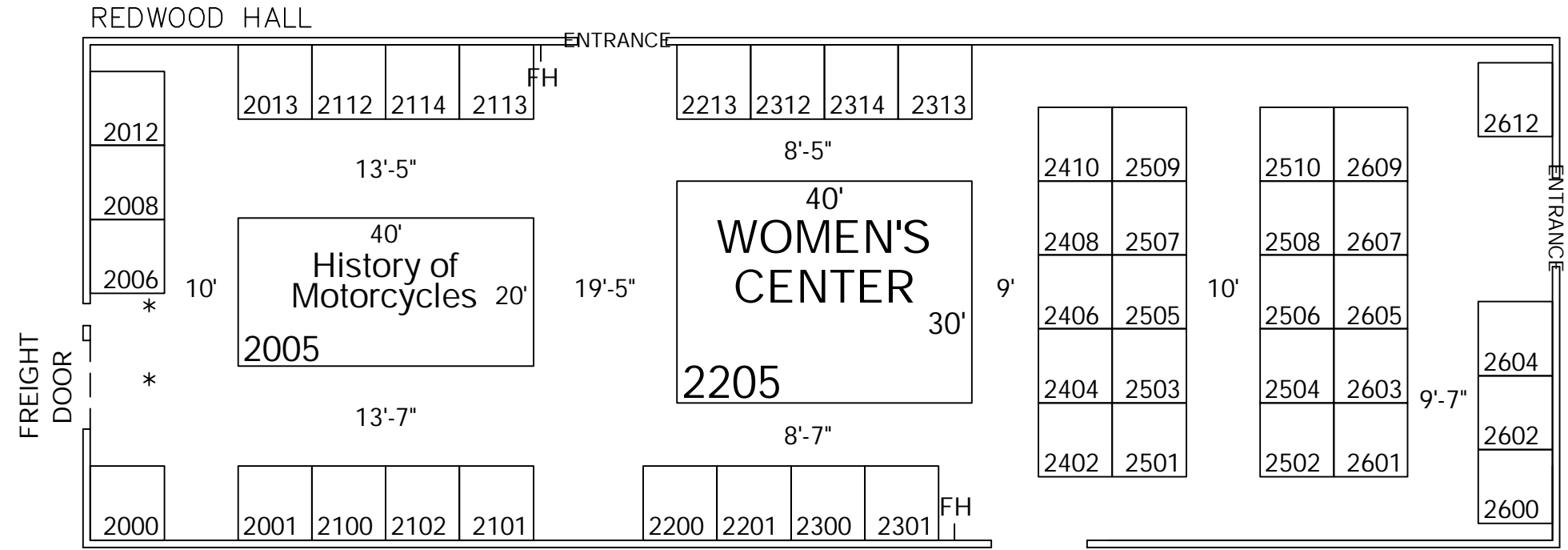

*—Last In/First Out Booths

PAVILION MEETING RM. 30'-9" 22'-9"

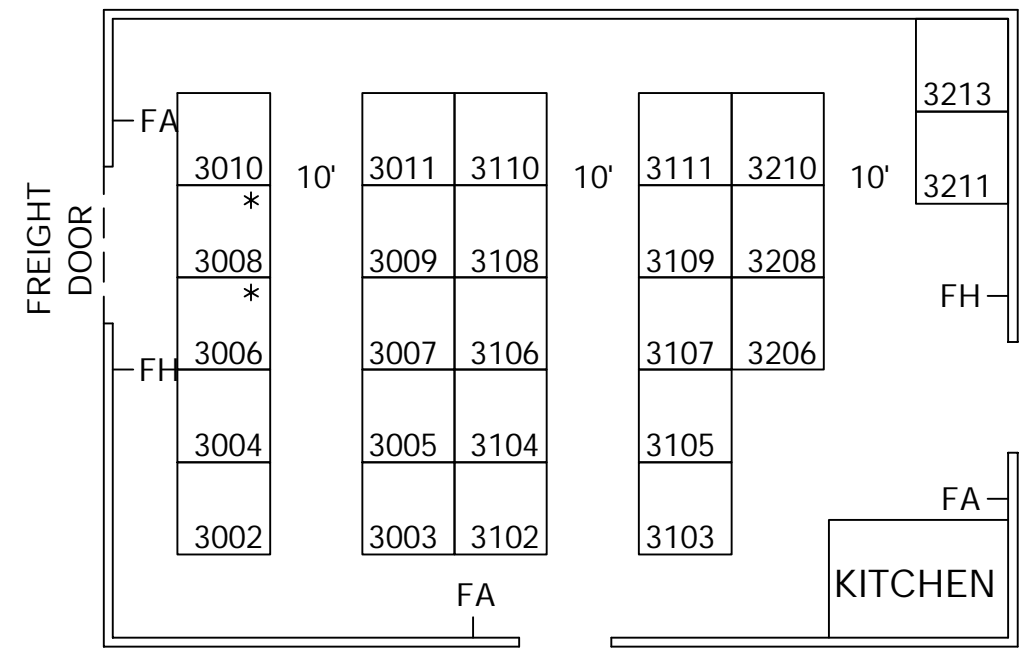

SEQUOIA HALL

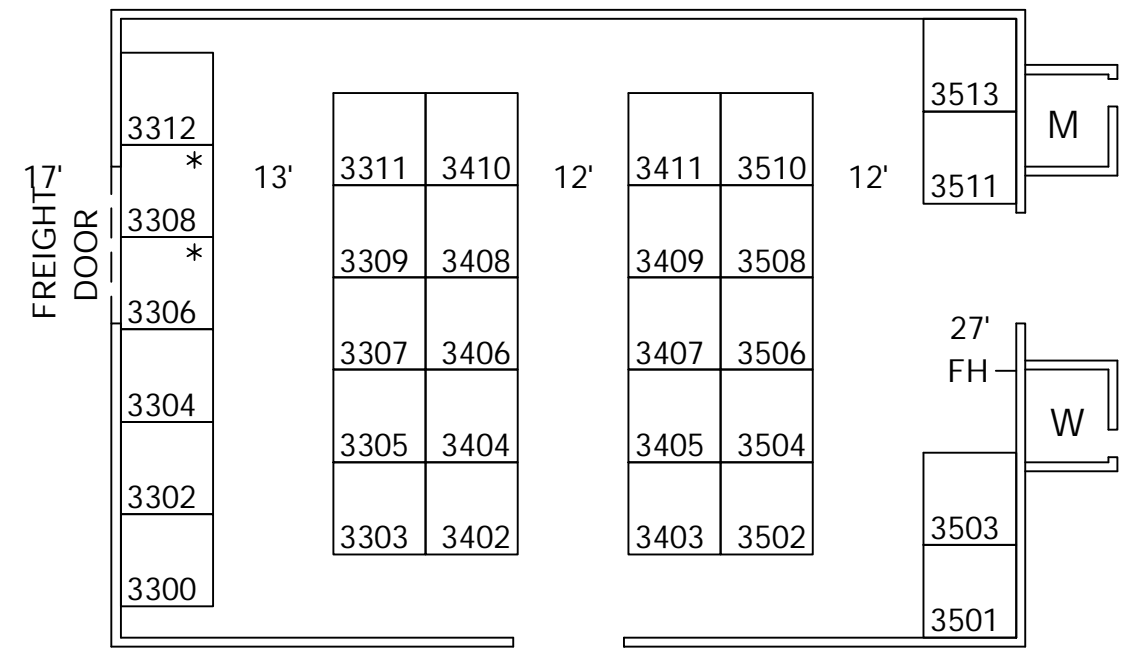

NO CA INTL MOTORCYCLE SHOW
 NOVEMBER 20-22, 2009
 SAN MATEO EXPO CENTER-REDWOOD, PAVILION, AND SEQUOIA HALL
 SAN MATEO, CA

FREEMAN

105 PARK LANE
 BRISBANE, CA 94005
 Phone: 415-330-6200
 Fax: 415-330-6201

SAN FRANCISCO DRAFTING & DESIGN

File Name:	NORTHERN MOTOR.DWG
Show Name:	NO CA INTL MOTORCYCLE
Show Dates:	11/20-22/09
Facility:	SMEC
Job Number:	228582
Acct. Exec:	DB

Scale: NTS

DISCLAIMER
 EVERY EFFORT HAS BEEN MADE TO ENSURE THE ACCURACY OF ALL INFORMATION CONTAINED ON THIS FLOORPLAN. HOWEVER NO WARRANTIES, EITHER EXPRESSED OR IMPLIED ARE MADE WITH RESPECT TO THIS FLOORPLAN. IF THE LOCATION OF BUILDING COLUMNS, UTILITIES OR OTHER ARCHITECTURAL COMPONENTS OF THE FACILITY IS A CONSIDERATION IN THE CONSTRUCTION OR USAGE OF AN EXHIBIT, IT IS THE SOLE RESPONSIBILITY OF THE EXHIBITOR TO PHYSICALLY INSPECT THE FACILITY TO VERIFY ALL DIMENSIONS AND LOCATIONS.

©RIGHT 2009, FREEMAN DRAFTING CO. ALL RIGHTS RESERVED.